



Interactive
PDF

ELOCK2

Download PDF



School Solution

INNOVATIVE ACCESS SOLUTIONS FROM
THE FIRST PLACE WINNER

MADE IN GERMANY



More security
in daily school life





Automatic lock V5
with AMOK function



Intelligent emergency
exit protection
TW4S door guard



Automatic lock V5
for the teachers'
room



Programming device
and software
SLS600



Elevator control for teachers
and students with
handicap



Furniture lock K-Series
for office furniture in
Teachers room



Tubular frame lock
R Series



All-glass door lock
G-Series



Access terminal Z85AP
for door openers and
sliding doors

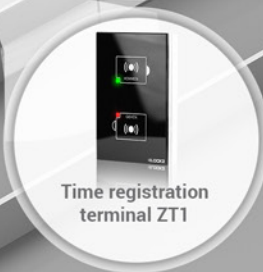

Time registration
terminal ZT1

The clever total solution

Safety for schools at all levels

Whether by politicians, parents or the general public, the demands placed on schools in terms of safety are increasing. At the same time, they are expected to meet the high demands of education and economic efficiency. The innovative and user-oriented electronic locking systems from Elock2 help to reconcile these contradictory goals.

ELOCK2 locking systems are modular in design and can also be installed retroactively and area-by-area. They thus offer an individual and economical solution for a transition to a secure environment.

Don't just open classroom doors with your transponder! Use your transponder for the entire school day:

Sensitive data, such as exam questions, report cards and class assignments are protected from unauthorized access by our furniture locks - opening only possible by authorized transponders. Valuable teaching materials can be stored securely in rooms or cabinets - only subject teachers have access via their transponders. In sports halls, partition walls, electric skylights or lighting can be operated via transponders. Countless other areas of application, such as time recording, meal booking, parking barrier control and many more are conceivable. Use the TW4S door guard to monitor emergency exit doors.

Even in the event of a crisis, you are well protected with ELOCK2 in the event of hostage-taking or amok threats.

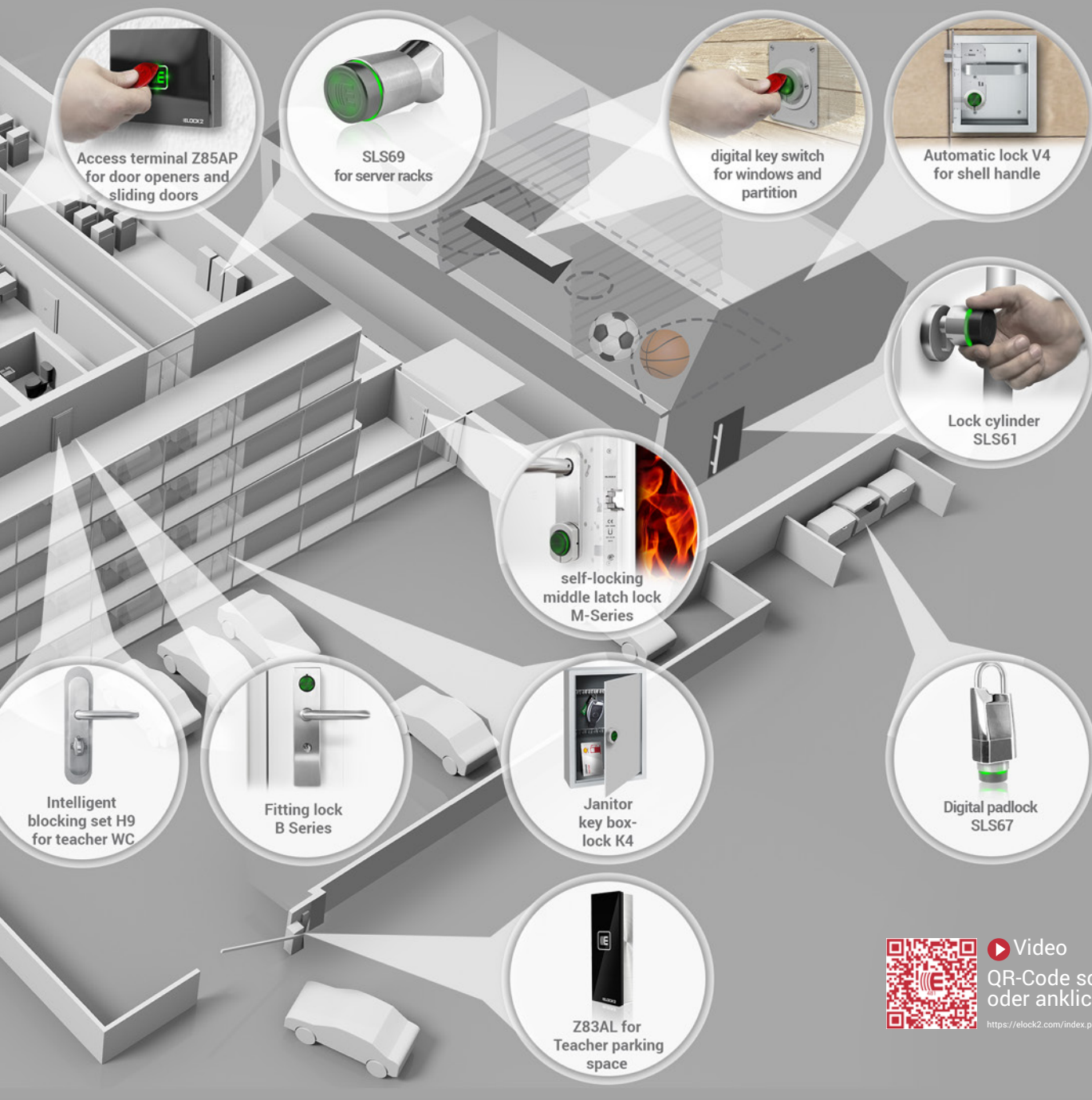

Children, pupils and students

need better protection in everyday life, but also in special situations, so that the wrong person cannot be in the wrong place at the wrong time. Nevertheless, they should retain the open and friendly atmosphere of their environment.

Teacher

need uncomplicated access to buildings, classrooms, teachers' rooms, toilets, etc. with just one key. The loss of a key must not lead to a financial disaster and jeopardize the security of people and assets. The locking system has to lock doors automatically at the end of lessons so that there are no more "forgotten doors".

Rectors

need an effective means of counteracting vandalism and theft and responding quickly to dangerous situations. You should be able to determine and implement differentiated access authorizations easily and efficiently.

Real Estate Offices & Facility Management

need master key systems that are cost-effective and offer efficient key management, even across multiple properties. To achieve this, they must be service providers (e.g., tradesmen and cleaning services) must be able to gain access for a limited period of time.

Main entrance



Teacher or
service provider



Z83ANTS with
validation-
function

Open door or
authorizations and opening hours
intelligently at the entrance terminal
update

Access control - easy and effective



Assign access permissions intelligently

Daily access authorizations can be activated either manually or automatically.

The way it works:

At central points in the building (e.g. at the main and side entrances), so-called validation terminals (model VT1) are installed.

The terminal is intended exclusively for activating transponders. Arriving persons present their transponder key at the terminal. The access rights previously stored for them are automatically activated for a defined period of time (e.g. 1 day, 1 week, 3 months). After the period of validity has expired, the transponder must be presented again at the terminal for activation.

If access authorizations for a person are to be changed (e.g. change of task, relocation), their transponder must be provided with a new locking plan at a master terminal (model MT1). After that, the daily transponder activation can be done again at any terminal (master or validation terminal).

In offline mode (e.g. if network connection is not available), programming is performed offline via a programming transponder.

The assembly

The controllers fit into a normal switch box and are compatible with many switch programs. The antennas can be mounted spatially separated.

Available versions



System Z83ANTS with stainless steel / glass housing



System Z83AP with glass housing



System Z83ANTA with stainless steel rosette



System Z83UP mit Blind cover (format 55)



V4 for teachers room:
A secure feeling and more comfort

V5 with access control

Challenge: Forget to lock

The solution: high quality automatic lock



There is no need for tiresome opening and closing. When the door is closed, the lock locks automatically and optionally time-controlled in accordance with insurance regulations. ELOCK2 locks with panic function can always be unlocked/opened from the inside (a single movement by operating the door handle).

Locking

Self-locking mechanism

Simply pull the door shut - done! The lock automatically locks itself after the door is closed.

End "Permanent open"

The valid transponder is pressed onto the reader button. The lock confirms the authentication with acoustic and optical feedback and locks automatically.

Time control

The lock locks itself for the set time by the time control.

Networking

If a network connection is available, the lock can be locked via the network by the ELOCK2 system software or a connected alarm system.

Unlocking

Open

With the door locked, the valid transponder is pressed onto the reader button. The lock confirms the authentication with acoustic and optical feedback. The door can now be opened with the lever handle.

Limit

The lock can be unlocked by transponders with restricted access authorisations within set time windows.

Time control

The lock unlocks itself on set weekdays at defined times by its time control.

Networking

If a network connection is available, the lock can be remotely unlocked by the ELOCK2 system software via the network.



door closed = automatically locked

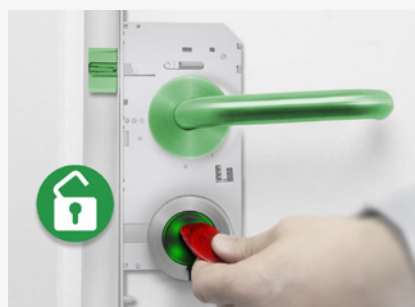

unlocking



open

Safety at the push of a button!

The emergency function of the V5 lock



Emergency button on the room side



Video
QR-Code scannen
oder anklicken

<https://elock2.com/index.php?id=481>

V5 for classrooms

Safety feature for emergencies, retrofitting with little effort

There are incidents in every school operation: The worst scenario imaginable is a rampage. With ELOCK2 you are optimally protected. As soon as an amok alarm is sounded via the ELA system, students and teachers have to lock themselves in the classroom: With ELOCK2, this is not necessary - the locks go into emergency mode in the event of an emergency. Access to the classroom is locked, the door can always be opened from the inside.



The teacher opens the door with an authorized transponder. The classroom function ensures that the classroom is accessible to students without a transponder during lesson times.



The emergency locking system - autarkic and individual: The lock can be locked from the inside against access from the outside by pressing the emergency button (without transponder).

The emergency lock - central and online:

If a network connection is available, the lock can be locked by a connected alarm system via network.

Escape direction always free:

Unlocking and opening from the inside is always possible via the door handle. The blocking on the outside still exists.

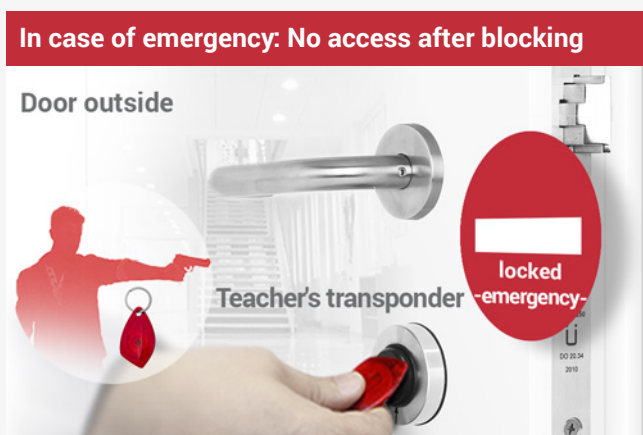

The teacher transponders are locked for the duration of the alarm and can no longer open doors. This prevents the assassin from extorting the key from the teacher.



Only the emergency transponder can now open the doors. This is deposited with the police, for example. Once the amok alarm is over, all teachers' transponders are released again and can be used normally.



Video
QR-Code scannen
oder Link anklicken
<https://elock2.com/index.php?id=577>



Infomaterial TW4S
QR-Code scannen
oder Link anklicken
<https://elock2.com/index.php?id=576>



emergency exit



Intelligent protection of escape routes

Unauthorized person



Authorized person



Open without alarm



The escape route: the most important facts in brief

Für Fluchtwege gelten gesetzliche und baurechtliche Vorschriften. Diese sind vom Besitzer bzw. Betreiber bereits bei der Planung zu beachten.

- Escape routes, as well as emergency exits and emergency exits must be kept clear at all times so that they can be used at any time. An escape route must be clearly identifiable and permanently marked.
- In the event of a power failure, electrical interlocking systems must
In the event of a power failure, electrical locking systems in the escape route must open automatically.
- An annual inspection of existing escape route by trained personnel is recommended, saves lives and can and can save costs in the long term.
- Non-compliance can result in fines and loss of insurance coverage.

The TW4S door guard complies with these regulations and may be used on escape doors.

Short-time release or permanent release

Emergency exit doors secured with the TW4S door guard can be accessed in both directions with an authorized transponder. In addition, these doors can be released for a freely definable time or permanently.

Coupling with a fire alarm system or Intrusion alarm system

Depending on the solution variant, one or more entrances are available for connection to a fire alarm system (FAS) or burglar alarm system (BMA). When the fire alarm system is triggered, a door can be released and locked again after the system has been reset.

Bidirectional escape route guarding for doors with escape exit function in both directions

If an escape door separates different fire compartments and at the same time different usage units, the escape route must be accessible in both directions in emergency situations. This requires special system solutions.

The solution:

With the TW4S door guard from ELOCK2, doors can be safely accessed from both sides at all times in the event of danger. No additional electrical locking elements are required. The combination of the TW4S escape route safety system and the V1E self-locking panic lock ensures reliable and barrier-free opening and closing of the doors.

Entering the door in an emergency

In the event of danger, the door can be safely accessed from both sides at all times via the TW4S door guard. In addition, it is possible to control external signal transmitters via an alarm contact or to forward a message to a building control system.

Your added value at a glance:

- Monitoring function that can be switched off according to schedule
- Event logging of walk-throughs
- Alarm acknowledgement and release by transponder
- Keyless alarm acknowledgement by MorseCode
- Deterrent pre-alarm on light actuation, silences on release
- Seamless integration into access management
- Battery operated in stand-alone mode



Blocking set H9 for sanitary rooms



If the toilet is occupied, the door cannot be opened from the outside even with an authorized transponder.

“Please don’t disturb”

This system prevents unauthorized use of the teacher’s WC by students; only authorized persons (e.g. teachers) can open the WC door with a transponder. The H9 locking set on the inside can be locked manually, i.e. without a transponder. Here, locking is done in the usual way using the mechanical rotary knob. In this locked state, no other transponder has the possibility to unlock the door from the outside. When the user leaves the WC or presses the handle of the locking device, the door lock is automatically unlocked and access from outside is prevented.

and access from the outside is released again.

Access with the general transponder or with a specific specific authorization is possible at any time.

The system is also suitable for meeting rooms.

Features

- User-friendly operation due to intuitive mode of operation
- Fulfills legal requirements for secured escape and rescue routes
- Time and calendar control possible
- In the outdoor area for the following designs:
 - Short and long plate fittings for framed doors
- Robust mechanical activation and deactivation of the locking function
- Opening in case of emergency with the general transponder



Infomaterial H9
QR-Code scannen
oder Link anklicken

<https://elock2.com/index.php?id=683>



EDW0110SCS0144R000004

Intelligent gym equipment

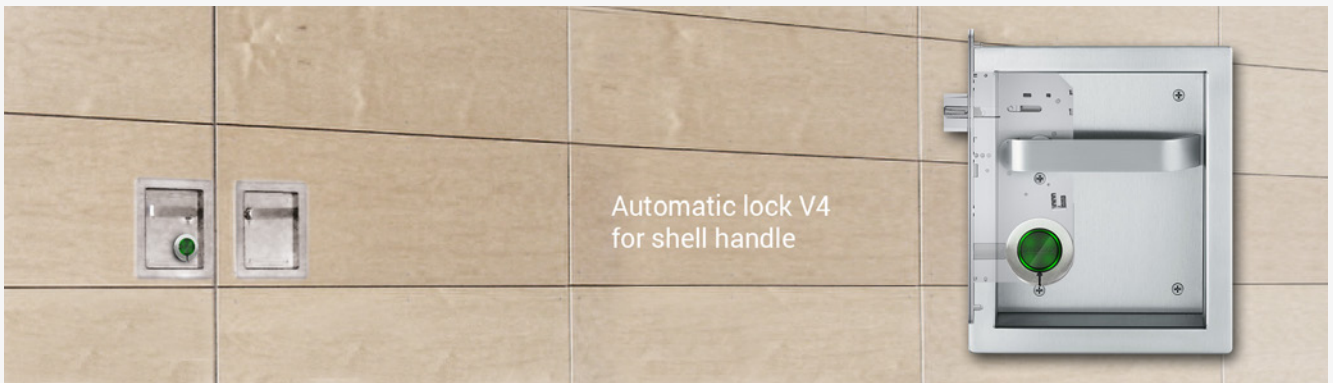

More safety in sports halls

To prevent injuries on doors, ELOCK locks can be installed in doors with shell handles. Here, too, there is no need for tiresome opening and closing. When the door is closed, the lock locks automatically and optionally time-controlled in compliance with insurance regulations. The ELOCK2 locks with panic function can always be unlocked/opened from the inside.



Intelligent Key Switch - The ELOCK2 Controller SLS83/ SLS85

In the sports hall, the partition walls, electric overhead lights and lights can additionally be operated with transponders. The controllers fit into a normal switch box and are compatible with many switch programs. The reading antennas can be mounted spatially remote.

Time wasted looking for keys?
That's in the past!



**One transponder
for all doors**

Challenge:

Too little time for core tasks

The solution:

Simple management

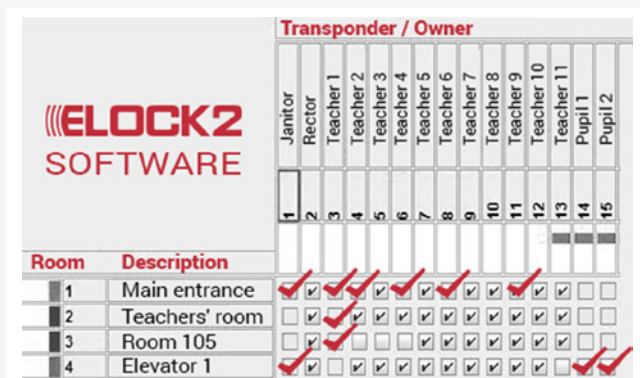

| ELOCK2 SOFTWARE | | Transponder / Owner | | | | | | | | | | | | | | |
|-----------------|----------------|---------------------|--------|-----------|-----------|-----------|-----------|-----------|-----------|-----------|-----------|-----------|------------|------------|---------|---------|
| Room | Description | Janitor | Rector | Teacher 1 | Teacher 2 | Teacher 3 | Teacher 4 | Teacher 5 | Teacher 6 | Teacher 7 | Teacher 8 | Teacher 9 | Teacher 10 | Teacher 11 | Pupil 1 | Pupil 2 |
| 1 | Main entrance | ✓ | ✓ | ✓ | ✓ | ✓ | ✓ | ✓ | ✓ | ✓ | ✓ | ✓ | ✓ | ✓ | ✓ | ✓ |
| 2 | Teachers' room | | ✓ | ✓ | ✓ | ✓ | ✓ | ✓ | ✓ | ✓ | ✓ | ✓ | ✓ | ✓ | ✓ | ✓ |
| 3 | Room 105 | | ✓ | ✓ | ✓ | ✓ | ✓ | ✓ | ✓ | ✓ | ✓ | ✓ | ✓ | ✓ | ✓ | ✓ |
| 4 | Elevator 1 | ✓ | ✓ | ✓ | ✓ | ✓ | ✓ | ✓ | ✓ | ✓ | ✓ | ✓ | ✓ | ✓ | ✓ | ✓ |



Simple and flexible administration

The ELOCK2 system software allows immediate time-controlled and individual access permissions.

- New transponders and access permissions can be created by the operator himself. Unauthorised key copies are excluded.
- The ELOCK2 system software with its diverse configuration options allows changes to be made at any changes at any time.
- Locks, transponders and access authorisations can be flexibly can be flexibly adapted to changes in the organisational structure.
- Fast reaction in case of compromised security through the immediate blocking of transponders e.g. in case of key loss or critical personal data.
- Preventive security: temporary and/or time-dependent access time-dependent access authorisations. Calendar- and time-based definition of opening and closing times (e.g. tradesmen, cleaning companies, events etc.)

Zutrittskontrolle inklusive

Working time recording, access control and logging are integrated in the ELOCK2 system. System elements and software have the necessary interfaces.

How it works

You can use your PC to manage your entire locking system - easily and clearly. Connect the programming device to your PC via a USB cable. Now you can program remote control keys, locking cylinders, control modules and all other components. The information reaches the individual components from the programming device either wirelessly or via a data cable. The management software can be adapted to your requirements with additional software packages.

For self-sufficient offline components, access authorisations are stored on the individual transponder of the respective user. The transponder user thus brings his personal access rights directly to the offline component. If a valid access authorisation is present, the respective locking device releases the opening.

The key features

- Definition of user profiles for user groups, access areas and time zones
- Management of invalid and lost transponders
- Administration and issuing of guest/visitor contractor transponders
- Detailed reports on access activities
- Multi-user and multi-client capability, administration by several users
- Alarm triggering function



Infomaterial

QR-Code scannen
oder Link anklicken

<https://elock2.com/index.php?id=852>



high quality stainless steel

ELOCK2
M-Serie

Patented automatic lock
with panic function

20mm
automatic
full locking

Fire protection certified

highest safety

Effective protection through intelligent access control



Safety Award

You will receive innovative and high-quality access solutions from the first-place winner. ELOCK2 security technology is the result of years of practical experience.

Industry and DIN standardized

Profile cylinders, mortise, tubular frame and fitting locks are recognized by insurance companies as effective burglary protection and are approved for: Escape and rescue routes (special models), fire and smoke protection doors - in connection with panic devices.

Designed, developed & Made in Germany:

Development, production and support at ELOCK2 have been ISO-certified since 1991. ELOCK2 - everything under one roof: research, development, software and production. Short communication channels, customer requirements can be flexibly addressed at any time.

Easy to upgrade and convert

You get state-of-the-art technology that can be integrated into the existing doors or premises in no time at all without any conversion.

Pull, impact and breakage protection for locking cylinders

Our continuous cylinder shaft inside the cylinder protects the cylinder against destruction and break-in.

Highest security - protection against tampering:

The electronics located on the inside of the cylinder are effectively protected against attacks from the outside, for example with an external power source or via hacker software. In our locks, the electronics are located in the lock and thus secured inside the door leaf.

Long battery life

The system is not activated until the opening process. Until then, the locking cylinder is inactive and requires no energy.

Service:

Trained ELOCK2 service partners and ELOCK2 technical support assist architects and planning offices in planning and installation with short response times.

Flexible and expandable

All ELOCK2 locking and access control systems are modular and therefore flexible and expandable. Optimal for existing buildings and for modernizations. Since ELOCK2 locks and cylinders are individually configurable, you have the option of adapting your locking systems to your current requirements:

We offer a wide range of lock variants and accessories. Choose from the following categories:

- Handle pins in 9mm with customizable length.
- Lock variants for all door types: mechanical, digital battery operated or digital mains operated
- sets with different combinations of antennas
- handle sets in different shapes
- Vandalism protection for cylinders for indoor and outside

Add additional special functions

- Radio system, for existing and new installations
- Door guard/ day alarm for door control
- Alarm arm circuit for building monitoring

With ELOCK2 you have the choice of how you want to open your doors

- want to open:
- with transponder
- with MorseCode
- with smartphone
- via notebook via TCP/IP
- or via an external system such as SmartHome, push button, fingerprint etc. The possible combinations are almost infinite.



Mehr Infos über ELOCK2

QR-Code scannen
oder Link anklicken

<https://elock2.com/index.php?id=866>



References in Germany

Adalbert Stifter Schule, Esslingen
AWO-Kindertagesstätte, Halle (Westf.)
Berufliche Oberschule FOSBOS Krumbach, Günzburg
Berufsschule, Kitzingen-Ochsenfurt
Brötzinger-Schule, Pforzheim
Bundeshandelsakademie, Feldkirch/Österreich
Clara-Schumann-Gymnasium, Bonn
Deutenberg-Schule, Schwenningen
Dossenberger Gymnasium Günzburg
Edith-Stein-Gymnasium, Bretten
Ev. Johanniskirchengemeinde, Bonn
Ev. Kindertagesstätte, Bonn
Familien- und Jugendzentrum, Bruchsal
Finkenhof-Schule, Bonn
Freie Waldorfschule, Krefeld
Gemeinde Hartmannsdorf/Österreich
Gemeinde Mäder/Österreich
Gemeinde Schwarzach/Österreich
Gemeinde und Schule, Altach/Österreich
Gemeinde und Schule, Weiler/Österreich
Gemeinde und Schulzentrum, Bezau/Österreich
Gemeinde und Schulzentrum, Koblach/Österreich
Gemeindehaus, Marburg
Gemeindezentrum und Schulzentrum,
Gemeindezentrum, Götzis/Österreich
Gemeindezentrum, Reutlingen
Gemeindezentrum, Schlins/Österreich
Georg-Monsch-Sporthalle, Offenburg
Gerhard-Hauptmann-Schule, Halle (Westf.)
GHS Liebersbronn, Esslingen
GHS Wändenbronn, Esslingen
Grimmelshausen-Gymnasium, Offenburg
Grundschule Dillweißenstein, Pforzheim
Grundschule Hörste, Halle (Westf.)
Grundschule Kutenhausen, Minden
GrunGrundschule Künsebeck, Halle (Westf.)
GS Pliensauschule, Esslingen
Gymnasium Schulzentrum Nord, Esslingen
Hardtberg-Halle, Bonn
Haus der Begegnung, Bruchsal
Hebel-Gymnasium, Pforzheim
Helmholtz-Gymnasium, Bonn
Herderschule, Esslingen
Hilda-Gymnasium, Pforzheim
Holzgau/Österreich
HTL Ried, Innkreis/Österreich
Internationale Fachhochschule, Bad Honnef
Johann-Peter-Hebel-Schule, Bretten
Josef-Strunck-Halle, Bonn
Jugendtreff Albersbösch, Offenburg
Jugendzentrum, Halle (Westf.)
Justus-Knecht-Gymnasium, Bruchsal

Karl-Friedrich-Schule, Pforzheim
Käthe-Kollwitz-Schule, Bruchsal
Kepler-Gymnasium, Pforzheim
Kindergarten Finkenhof, Bonn
Kindertagesstätte St. Servatius, Bornheim
Kochschule, Bruchsal
Konrad-Adenauer-Schule, Bruchsal
Kulturhaus Osterfeld, Pforzheim
Kurt-Tucholsky-Gesamtschule, Minden
Lindenschule, Halle (Westf.)
Markgrafen-Realschule, Burgau
Matthias-Claudius-Schule, Bonn
Mehrzweckhalle Stemmer, Minden
Mörike Gymnasium, Esslingen
Mosaik-Schule, Minden
Musikschule, Bruchsal
Neckarsporthalle, Esslingen
Neckarsporthalle, Esslingen
Ratsgymnasium, Minden
Realschule Innenstadt, Esslingen
Reuchlin-Gymnasium, Pforzheim
Schanz-Schule, Pforzheim
Schillergymnasium, Pforzheim
Schiller-Schule, Bretten
Schönborn-Gymnasium, Bruchsal
Schulzentrum Masch, Halle (Westf.)
Sportheim Leteln, Minden
Sportpark-Nord, Bonn
Sportzentrum Masch, Halle (Westf.)
Städt. Kindergarten u. -tagesstätte, Bornheim
Städt. Musikschule, Esslingen
Stadthalle, Offenburg
Steinschule, Bruchsal
Stirumschule, Bruchsal
Theodor-Heuss-Gymnasium, Pforzheim
Turnhalle a. d. Grundschule Kirchhatten, Hatten
Volkshochschule, Esslingen
Volkshochschule, Pforzheim
Waisenhofschule, Esslingen
Weiherbergschule, Pforzheim
Weserstadion, Minden
Zollberg Realschule, Esslingen

Notizen

Ihr persönlicher Fachberater:

Innovative Zutrittslösungen vom erstplatzierten Preisträger



<https://elock2.com/index.php?id=368>

Produktkatalog als PDF



<https://elock2.com/index.php?id=581>

Neuigkeiten



<https://elock2.com/index.php?id=861>

Infomaterial Produkte



<https://elock2.com/index.php?id=860>

Infomaterial Systeme und Funktionen



<https://elock2.com/index.php?id=622>

Ausschreibungstexte



<https://elock2.com/index.php?id=621>

Zertifikate / Prüfdokumente

Technische und optische Änderungen der Produkte vorbehalten. Für Druckfehler und sonstige Irrtümer übernehmen wir keine Haftung.

Jetzt das ganze ELOCK2-System entdecken



Mechanische / digitale Automatikschlösser mit Panikfunktion



Digitale Schließzylinder (auch mit Panikfunktion)



Intelligente Fluchtwegsicherung



Digitale Vorhängeschlösser und Rohrtresore



Digitale Möbelschlösser



Zutrittsterminal z.B. für Türen und Schranken

ELOCK2 Zutrittsystem mit 360°-Perfektion

Patenterte Systeme und hochdifferenziertes Zutrittsmanagement mit der ELOCK2-Software mit Schnittstellen zu Alarm- und Datenbanksystemen (nach offenen Standards).

Die kabellose Montage in allen Standardtüren (auch Glas- und Rohrrahmentüren) senkt die Investitionskosten bei Neubau und Nachrüstung gegenüber verkabelten Systemen erheblich.

Ausgezeichnete Skalierbarkeit bei der Einführung und Erweiterung von Schließsystemen auch für unverbundene Objekte durch die virtuelle Vernetzung. Systeme sind für Brandschutztüren und Fluchttüren geeignet.

Hervorragender technischer Support für Hard- und Software von qualifizierten Servicepartnern und direkt vom Hersteller ELOCK2 - das mittelständische Familienunternehmen mit kurzen Wegen.

ELOCK2
MADE IN GERMANY

Qualität zertifiziert
nach DIN EN ISO 9001

Gutenbergstr.10-12
D-73779 Deizisau
vertrieb@elock2.de

Tel: +49(0)711 901213 - 80
Fax: +49(0)711 901213 - 99
www.elock2.com